



THE ESHER

2 bedroom semi-detached house
Plots 12 & 13

KNIGHTS GREEN

LOXWOOD | WEST SUSSEX

 ANTLER HOMES

antlerhomes.co.uk

The Esher is a carefully designed semi-detached home with a delightfully spacious, open-plan layout on the ground floor featuring underfloor heating as standard, and two good-sized bedrooms upstairs.

					
BEDROOMS 2	BATHROOMS 2	SPACES 2	AREA 842 SQFT	AREA 78.28 SQM	EPC (PREDICTED) B

Ground Floor

Kitchen
4.23m x 1.83m 13'8" x 6'0"
Living Room/Dining
4.67m x 4.33m 15'3" x 14'3"

GF

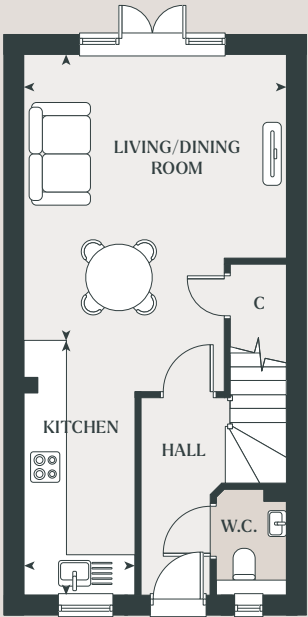

First Floor

Bedroom 1
4.33m x 3.33m 14'3" x 11'0"
Bedroom 2
4.33m x 2.92m 14'3" x 9'7"

FF

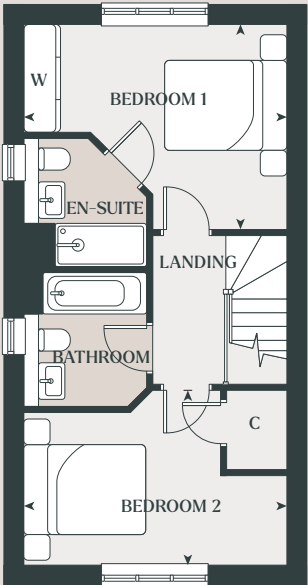

C – Cupboard W – Wardrobe

Details may vary from plot to plot. Dimensions are approximate and should not be used for furniture space, appliance space or carpet sizes. Please ask for details of your chosen plot. The contents of this document do not form or constitute a warranty or represent part of any contract. Please note: to increase legibility these plans have been sized to fit the page. As a result each plan may be a different scale to others within this document. CGIs are for indicative purposes only and can be subject to change.